

bottles & burps



FAST AND RELIABLE SHIPPING

Consistent, reliable and fast shipping and no surprises or excuses.



SIMPLY THE BEST

Biodynamic, non-GMO, and organic - sometimes less is more.



ALWAYS THERE TO HELP

Customer service just a text message or phone call away, 6 days a week, 18 hours per day.

HOLCD03

Holle Cow Milk Stage 3 Organic Follow-On Formula + DHA (600g)

Age: From 10-12 Months

Yield: Approximately 152oz of Formula

NEW 2022 formulation with DHA from a vegetarian source. Holle Stage 3 organic formula is used from the 10th month onward and is especially adapted to the growing nutritional needs of older infants. Holle Stage 3 should be part of a mixed diet and can be given via bottle or added to porridge. Holle Stage 3 Organic Follow-On Milk is gluten-free and is fortified with goodness that is essential for the growing nutritional needs of your little one.

Holle formula is based on milk from cows raised on biodynamic farms in Germany that are Demeter certified. The Demeter standard is truly the gold standard in terms of animal welfare and biodynamics. Demeter dairy farms avoid practices such as the painful dehorning of the dairy cows. The organic starches and maltodextrin used to make this formula creamy and satiating for your little one are also EU certified organic. Other ingredients include essential vitamins and minerals to promote your baby's development and meet EU regulatory requirements.



- ✓ Only Demeter Certified Biodynamic Dairy Farms
- ✓ No corn-based sweeteners
- ✓ Vitamins A, C, D and E for baby's immune system
- ✓ No gluten
- ✓ EU Certified Organic
- ✓ No GMOs
- ✓ DHA from vegetarian source



bottles & burps

Holle Cow Milk Stage 3 Organic
Follow-On Formula + DHA (600g)



INSTRUCTIONS

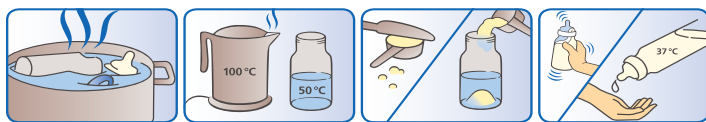

Preparation for all powdered formulas (also consistent with US FDA guidelines):

1. Boil water freshly for each of baby's meals and allow to cool down to 120 degrees Fahrenheit (50 °C) before mixing with formula powder.
2. Pour in ½ of the necessary amount of boiled water into a clean and sterilized bottle.
3. Using the scoop provided with your box of formula (note that spoon sizes vary by brand and even lot), add the correct number of leveled scoops of powder (1 leveled scoop of powder per 1oz / 30ml of water).
4. Close the bottle with the nipple and cap and vigorously shake.
5. Add the remaining half of the water to the bottle and shake again.
6. Cool to drinking temperature (approximately 98 degrees Fahrenheit or ~ 37 °C) and **ALWAYS** test the temperature of the milk before feeding to avoid scalding or burning your little one.

There are many mothers that regularly use distilled water without boiling it, apparently with no negative consequences. We cannot recommend this approach and there are actual reasons even the US FDA recommends pre-boiling tap or distilled water instead.

MIXING AND FEEDING INSTRUCTIONS (HOLLE COW STAGE 3)

AGE	BOTTLES PER DAY	WATER (OZ)	# OF SCOOPS
		5	5
10 Months & Up	1-2	6	6
		7	7

DON'T FORGET

- ONCE YOU HAVE OPENED THE INNER FOIL BAG CONTAINING YOUR FORMULA, YOU SHOULD USE WITHIN 2 WEEKS. AVOID STORING IN AREAS OF HIGH HEAT OR HUMIDITY.
- WE HIGHLY RECOMMEND STORING FORMULA POWDER IN AN AIRTIGHT CONTAINER.
- IF MIXED FORMULA IS NOT CONSUMED WITHIN AN HOUR, YOU SHOULD DISCARD IT.
- DO NOT MICROWAVE BOTTLES OR FORMULA.

INGREDIENTS

Organic Demeter skimmed milk, organic whey powder (partly demineralised), all organic vegetable oils (sustainably sourced palm oil, sunflower oil, rapeseed oil), organic maltodextrin, organic starch, calcium carbonate, potassium chloride, oil from the microalgae Schizochytrium sp. as DHA source, vitamin C, calcium salts of orthophosphoric acid, L-tyrosine, potassium citrate, sodium chloride, L-tryptophan, ferrous sulphate, zinc sulphate, vitamin E, magnesium carbonate, niacin, copper sulphate, pantothenic acid, vitamin A, thiamine (vitamin B1), vitamin B6, manganese sulphate, potassium iodide, folic acid, vitamin K, sodium selenite, vitamin D, biotin, vitamin B12.

Certified organic by EU standards.

NUTRITION FACTS

	Per 100 ml Formula	Per 100 Calories
Energy (kcal)	67.0	100.0
Protein (g)	1.4	2.1
Fat (g)	3.5	5.2
Of which:		
Saturated Fat (g)	1.0	1.5
Monounsaturated Fat (g)	1.9	2.8
Polyunsaturated Fat (g)	0.6	0.9
Linolenic Acid Omega-3 (mg)	56.0	83.6
DHA (mg)	14.0	20.9
Carbohydrate (g)	7.5	11.2
Of which:		
Sugars (Primarily Lactose) (g)	5.2	7.8
Lactose (g)	5.0	7.5
Starch (g)	0.8	1.2
Water (g)	90.0	134.3
Linoleic Acid Omega 6 (mg)	561.0	837.3

VITAMINS

Vitamin A (IU)	180.3	269.2
Vitamin D (IU)	64.0	95.5
Vitamin E (IU)	1.8	2.7
Vitamin K (mcg)	6.5	9.7
Thiamine (Vitamin B1) (mcg)	38.0	56.7
Riboflavin (Vitamin B2) (mcg)	130.0	194.0
Vitamin B6 (mcg)	37.0	55.2
Vitamin B12 (mcg)	0.11	0.16
Niacin (mcg)	360.0	537.3
Folic Acid (Folacin) (mcg)	10.8	16.1
Pantothenic Acid (mcg)	360.0	537.3
Biotin (mcg)	1.7	2.5
Vitamin C (Ascorbic Acid) (mg)	6.9	10.3

MINERALS

Calcium (mg)	60.1	89.7
Phosphorus (mg)	37.1	55.4
Magnesium (mg)	5.3	7.9
Iron (mg)	0.58	0.87
Zinc (mg)	0.45	0.67
Manganese (mcg)	5.0	7.5
Copper (mcg)	55.0	82.1
Iodine (mcg)	14.5	21.6
Selenium (mcg)	3.7	5.5
Sodium (mg)	25.0	37.3
Potassium (mg)	86.2	128.7
Chloride (mg)	51.3	76.6

OTHER ITEMS

Folate (mcg DFE)	18.1	27.0
------------------	------	------

DILUTED: EACH 149 ML (~5 FL OZ) CONTAINS 100 CALORIES.

Translated from original German labels as of September 16, 2023.

Converted to units and table format/order per US Title 21: Subchapter B: Part 107.



organic